

# MASTER/EXC JWW

08/07/21- CENTRAL NY SHETLAND SHEEPDOG CLUB -JUDGE LINDA ROBERTSON

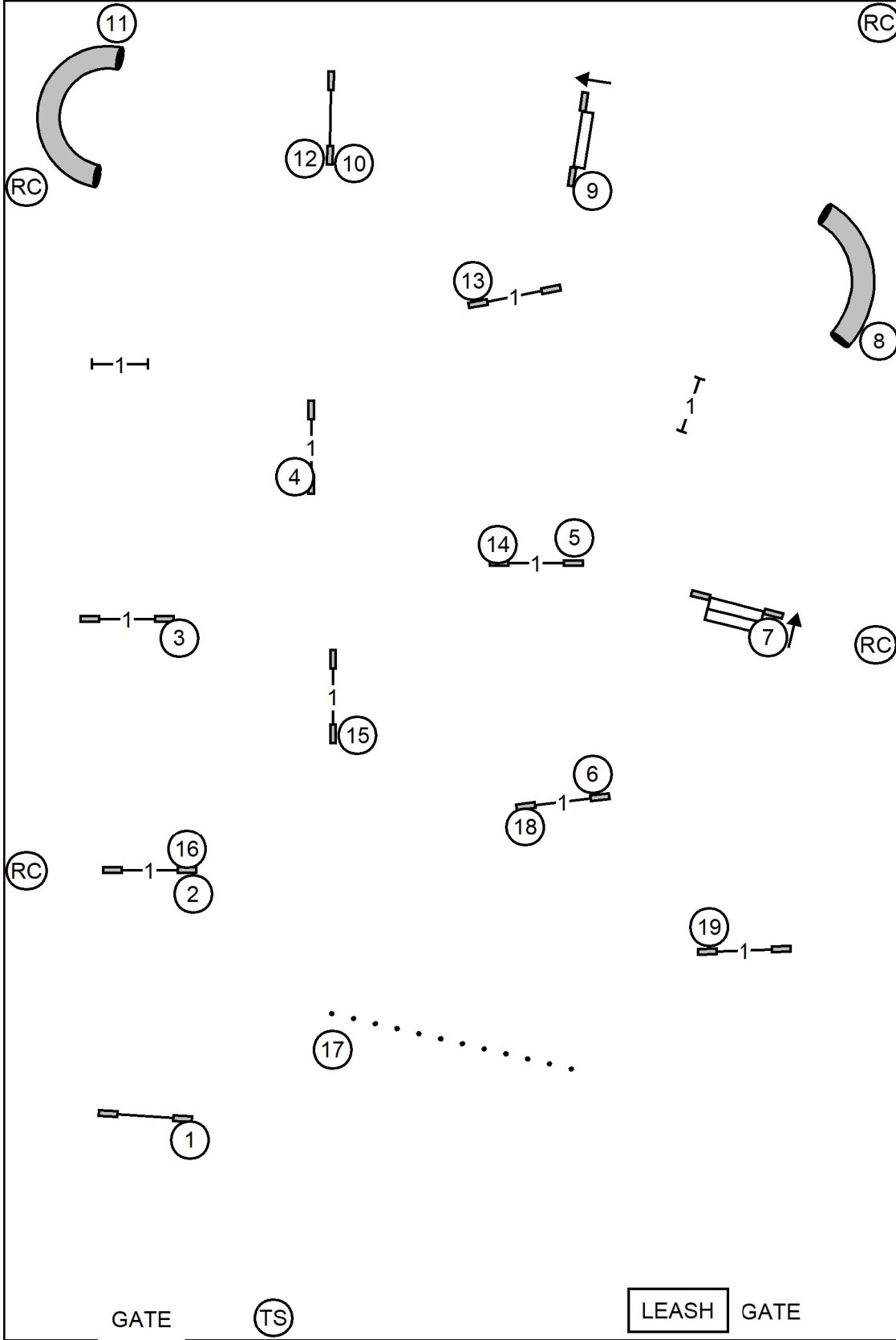

ENTER ON LEAD @ 17/18 - WAIT FOR TIMER "GO"

# OPEN JWW

08/07/21- CENTRAL NY SHETLAND SHEEPDOG CLUB -JUDGE LINDA ROBERTSON

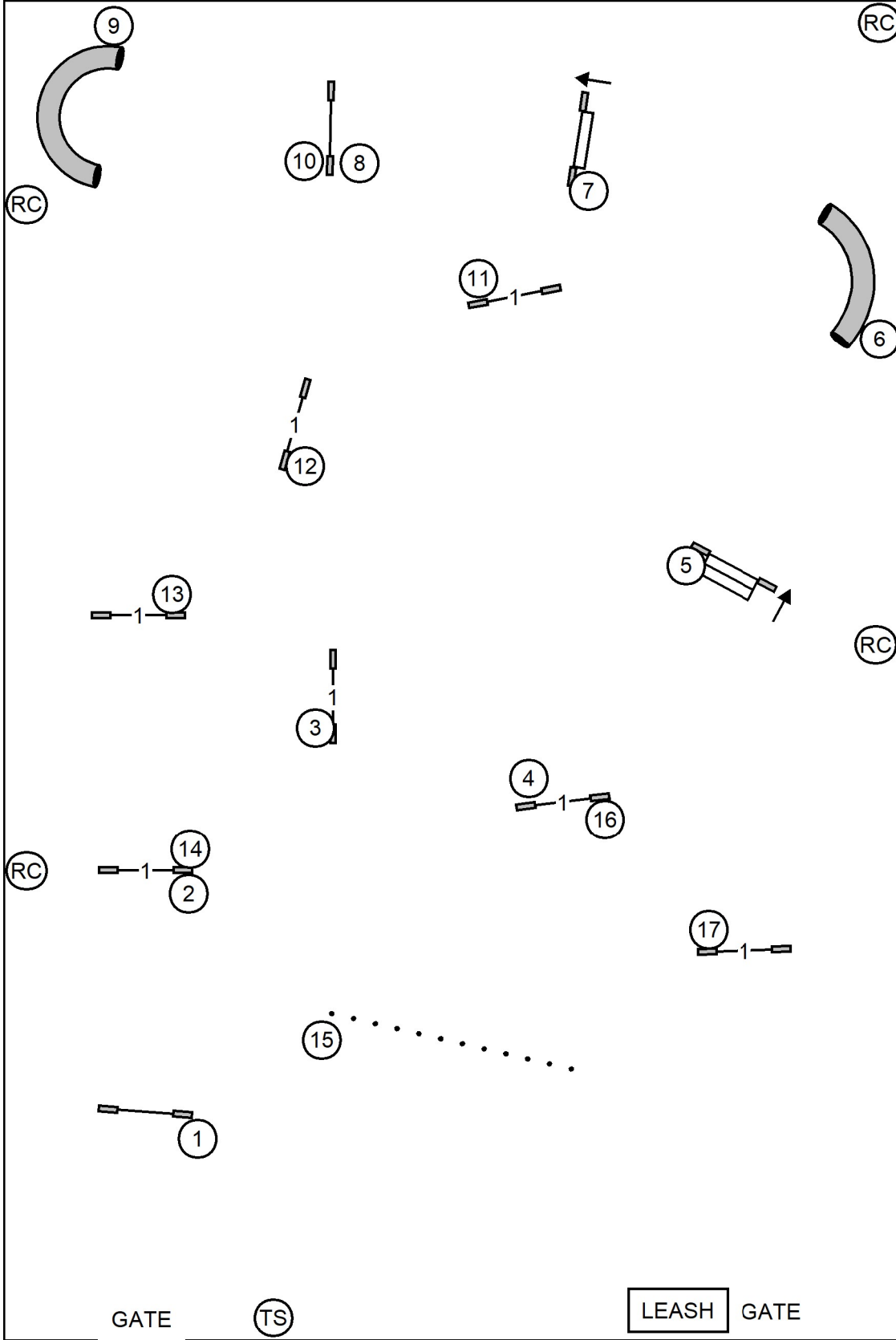

ENTER ON LEAD @ 15/16- WAIT FOR TIMER "GO"

# NOVICE JWW

08/07/21- CENTRAL NY SHETLAND SHEEPDOG CLUB -JUDGE LINDA ROBERTSON

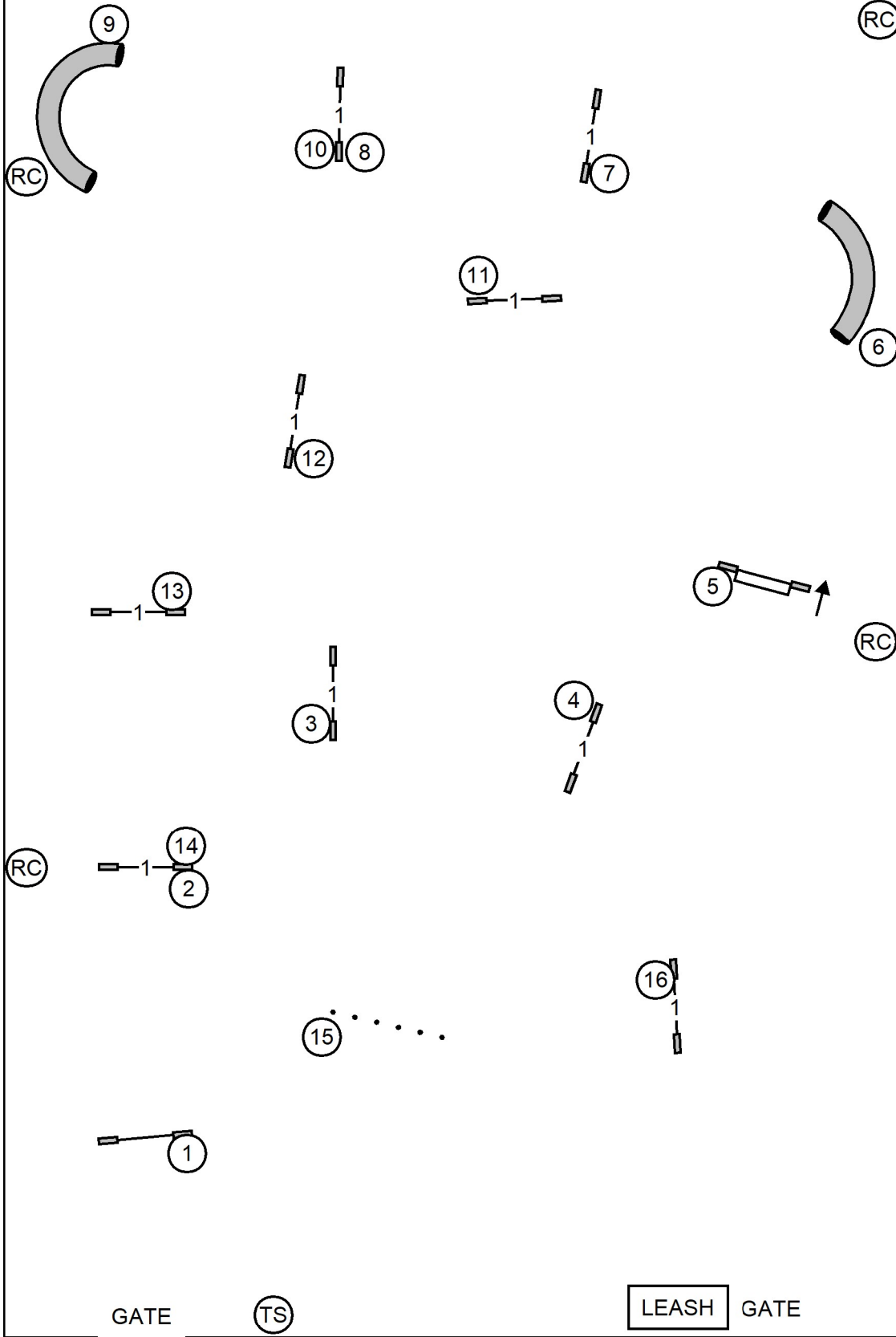

ENTER ON LEAD @ 15- WAIT FOR TIMER "GO"



# F.A.S.T. - ALL LEVELS

08/07/21- CENTRAL NY SHETLAND SHEPDOG CLUB -JUDGE LINDA ROBERTSON

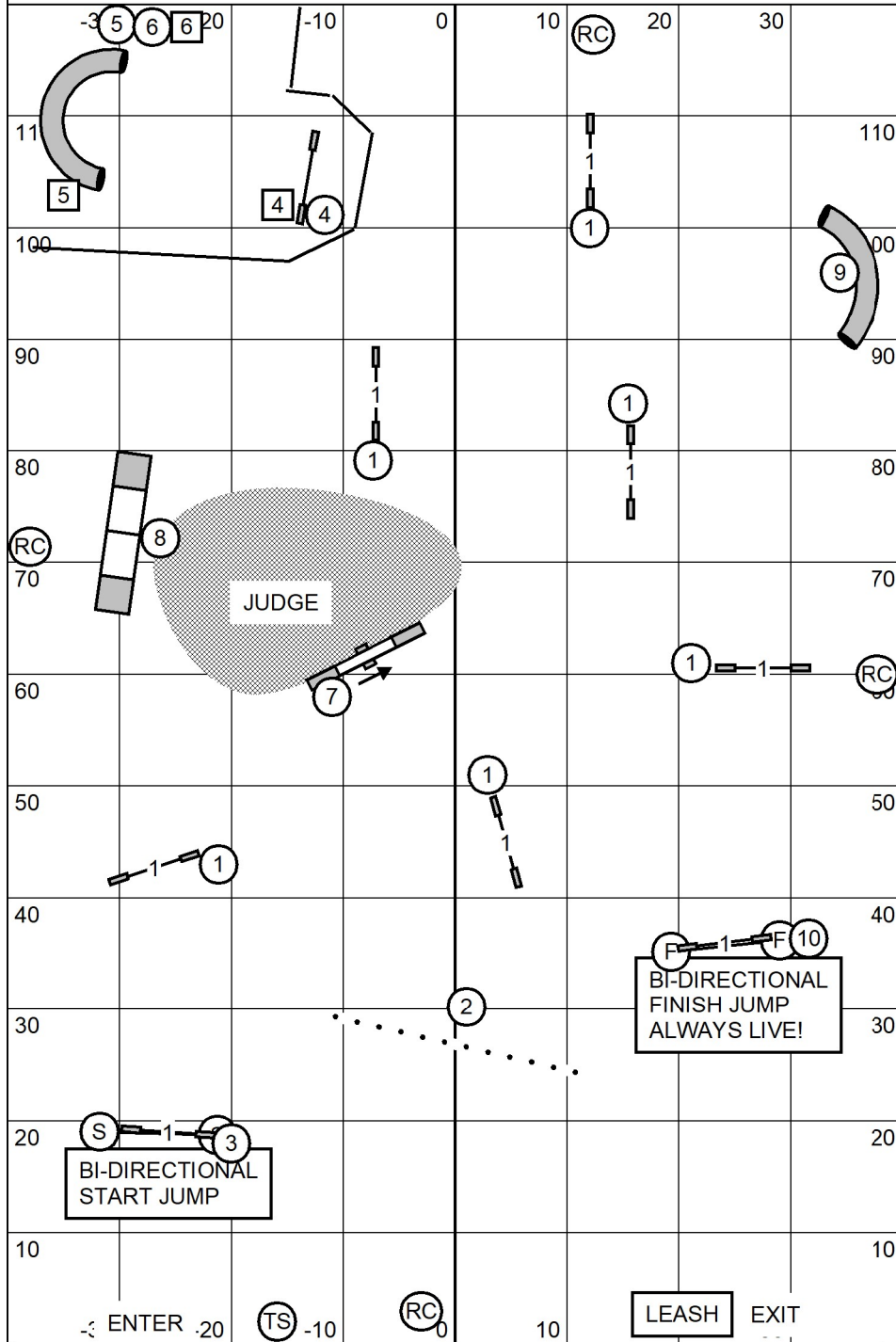

XM SEND = CIRCLE 4-5-6 IN FLOW - SOLID LINE  
 OP SEND = CIRCLE 4-6 or SQUARE 6-4 SOLID LINE  
 NOV SEND = SQUARE 5-4 or CIRCLE 4-SQUARE 5  
 SOLID LINE

Points to Q = 60 for XM, 55 for OP, 50 for NOV.

Reg CT: 38 sec-8 in, 35 sec-12/16 in, 32 sec-20/24/26 in;

Pref CT: 41 sec-4 in, 38 sec-8/12 in, 35 sec-16/20

# PREMIER STANDARD

08/07/21- CENTRAL NY SHETLAND SHEPDOG CLUB -JUDGE LINDA ROBERTSON

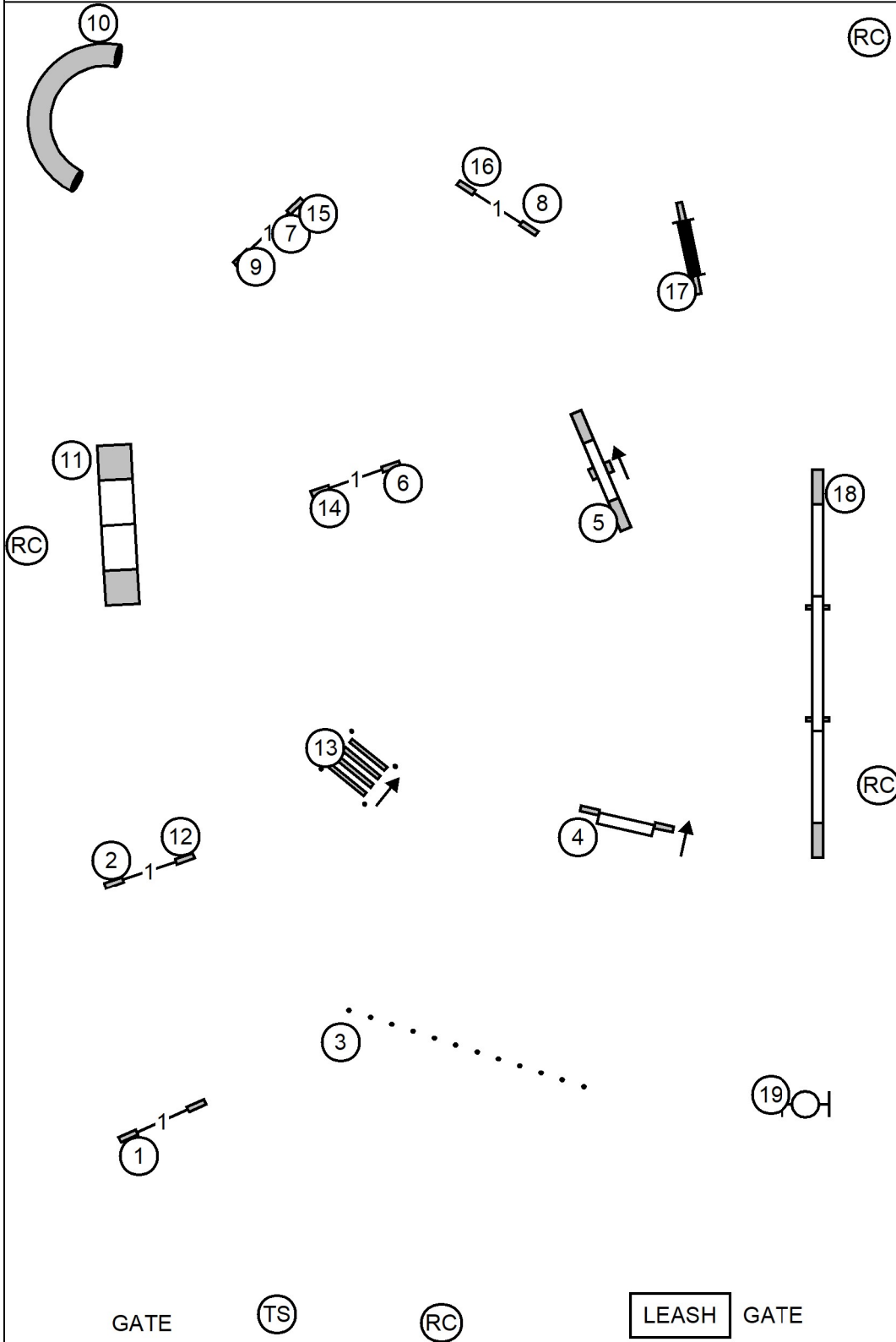

ENTER ON LEAD @ 16 - WAIT FOR "GO"

**REG MCT: 20/24C=55, 24/16=60, 8/12=65;**

**PREF MCT: 16=60, 12/20=65; 4/8=70**

# MASTER/EXC STD

08/07/21- CENTRAL NY SHETLAND SHEEPDOG CLUB -JUDGE LINDA ROBERTSON

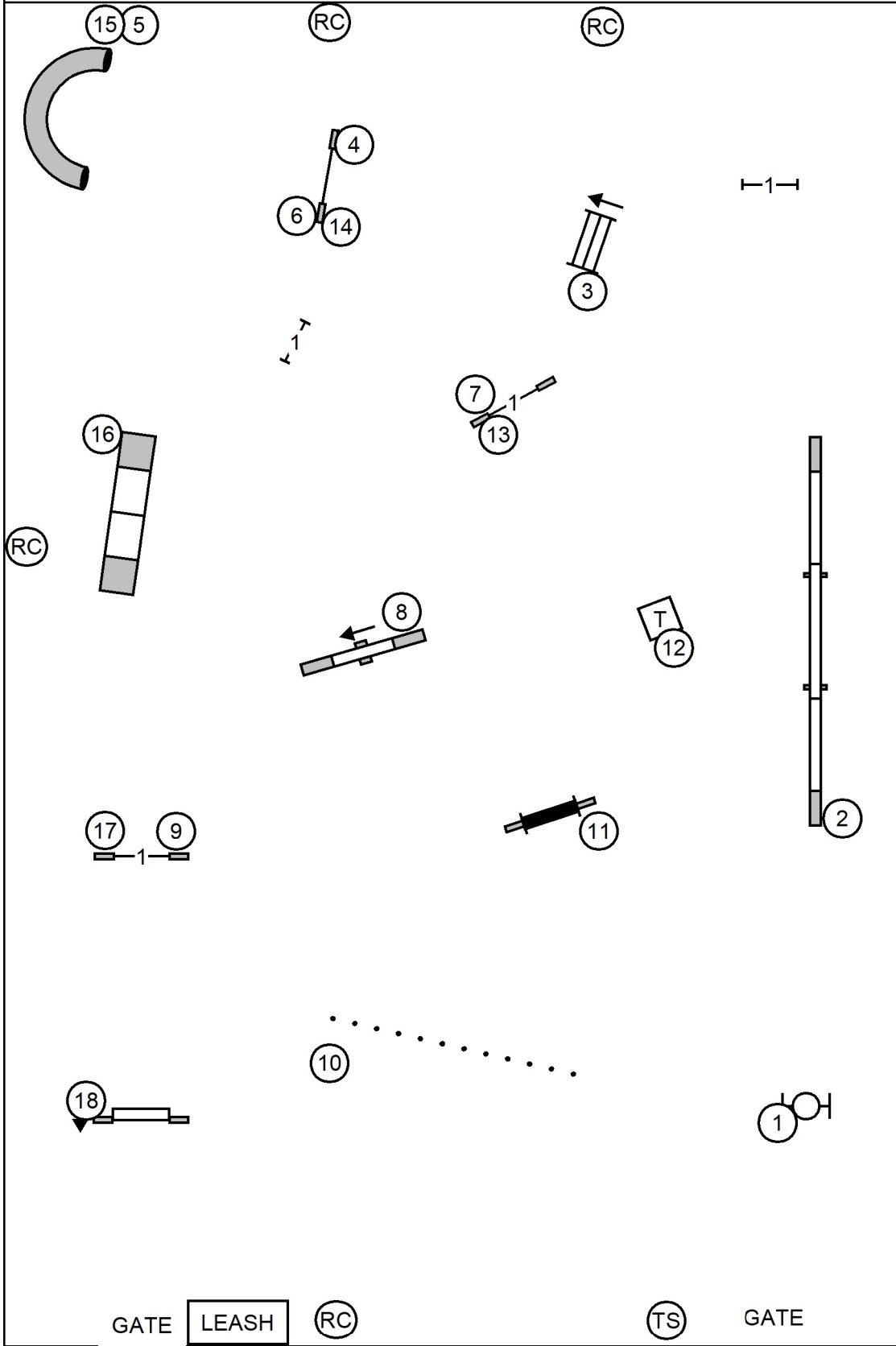

ENTER ON LEAD @ 14 - WAIT FOR TIMER "GO"

# OPEN STANDARD

08/07/21- CENTRAL NY SHETLAND SHEEPDOG CLUB -JUDGE LINDA ROBERTSON

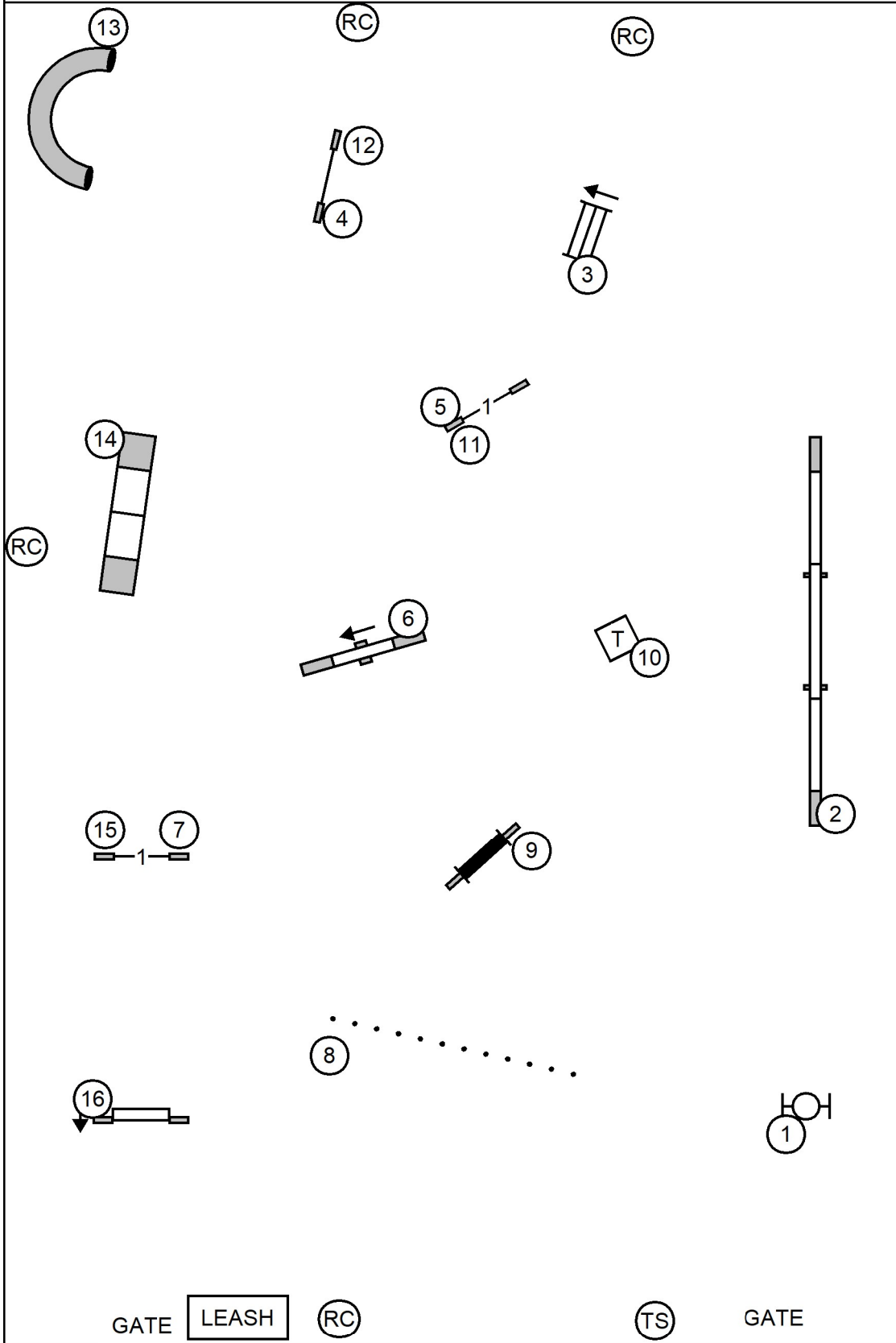

ENTER ON LEAD @ 12-13 - WAIT FOR TIMER "GO"



# NOVICE STANDARD

08/07/21- CENTRAL NY SHETLAND SHEEPDOG CLUB -JUDGE LINDA ROBERTSON

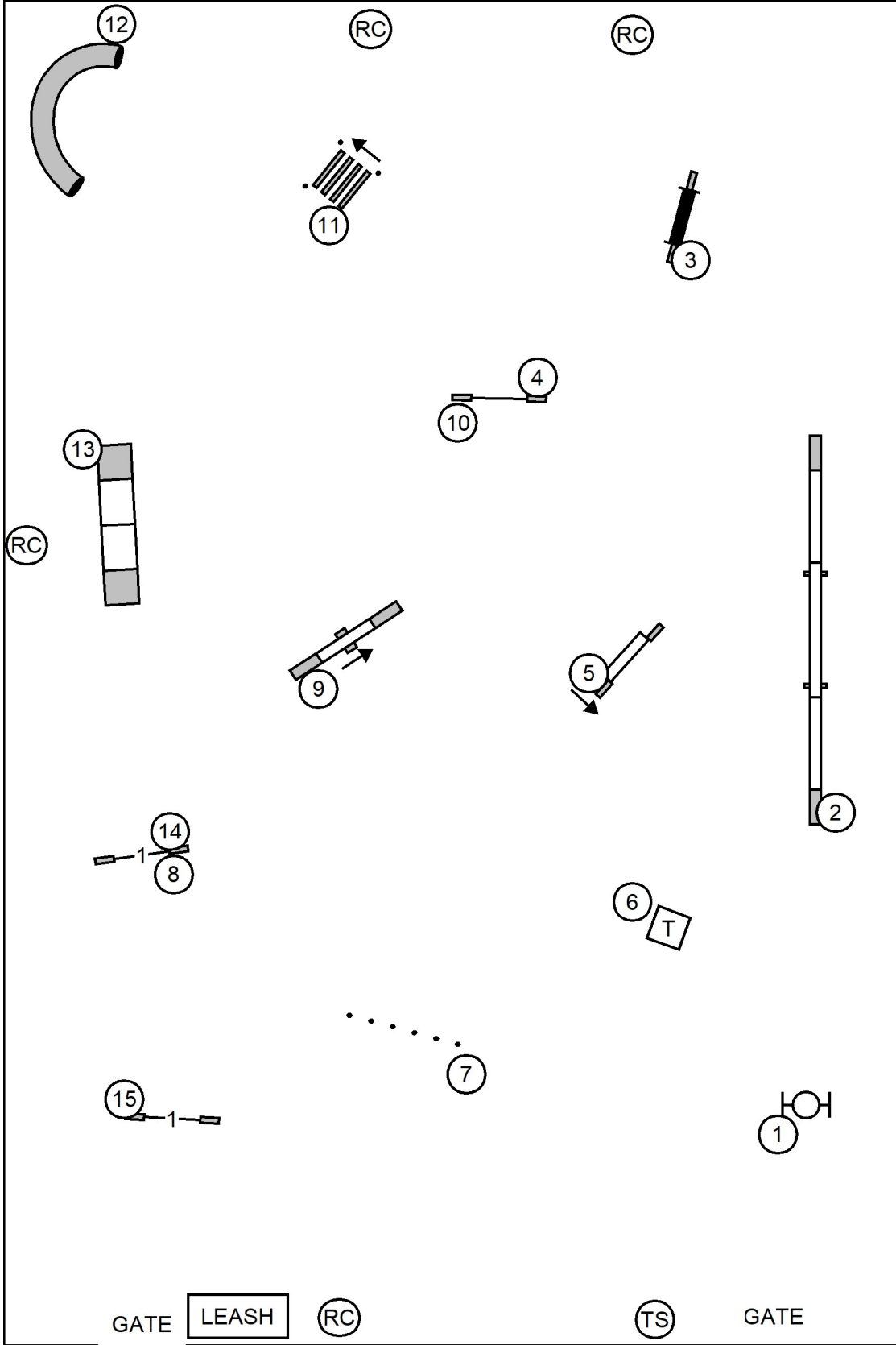

ENTER ON LEAD @ 11 - WAIT FOR TIMER "GO"